

**Notes**

1. Do not scale this drawing. All dimensions must be checked/ verified on site.
2. This drawing is to be read in conjunction with all relevant architects, engineers and specialists drawings and specifications.
3. All dimensions in metres unless noted otherwise. All levels in metres unless noted otherwise.

For cross sections, see Document 2.30B (HRF-BWB-GEN-XX-SK-CH-SK150)

P01	08.01.24	For Information	DF	SC
Rev	Date	Details of issue / revision	Drw	Rev

**Issues & Revisions**

Birmingham | 0121 233 3322  
 Leeds | 0113 233 8000  
 London | 020 7407 3879  
 Manchester | 0161 233 4260  
 Nottingham | 0115 924 1100  
[www.bwbconsulting.com](http://www.bwbconsulting.com)

Client

Project Title

**HINCKLEY NATIONAL RAIL FREIGHT INTERCHANGE**

Drawing Title

**ASTON FIRS SECTION LOCATION PLAN**

Drawn:	D.Fraser	Reviewed:	S.Carter
BWB Ref:	NTT2814	Date:	08.01.24
Scale:	@A1: 1:500		

**FOR INFORMATION**

Project - Originator - Zone - Level - Type - Role - Number	Status	Rev
HKF-BWB-GEN-XX-SK-CH-SK149	S2	P01

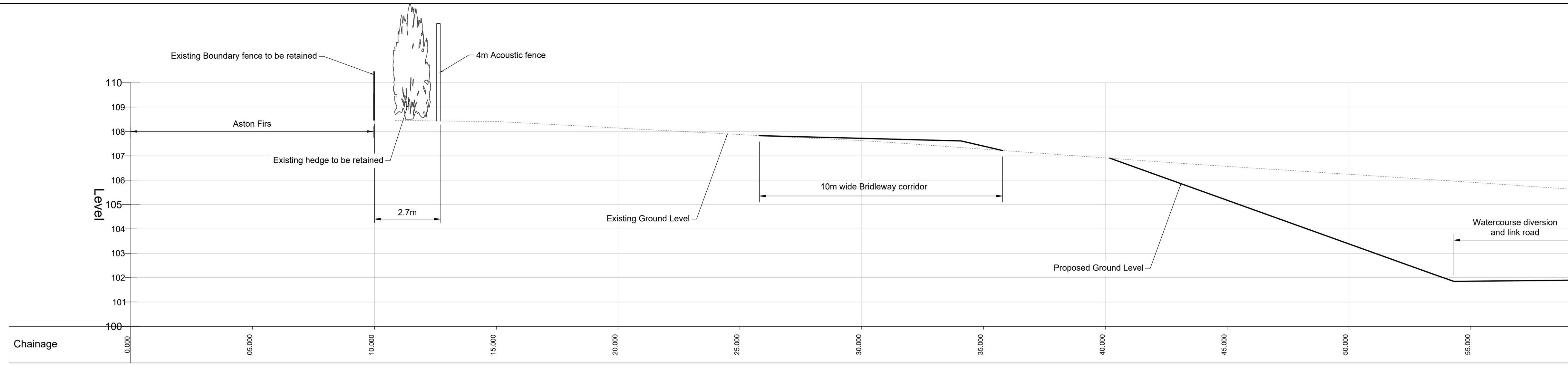

SECTION 1  
SCALE: H 1:100, V 1:100. DATUM: 100.000

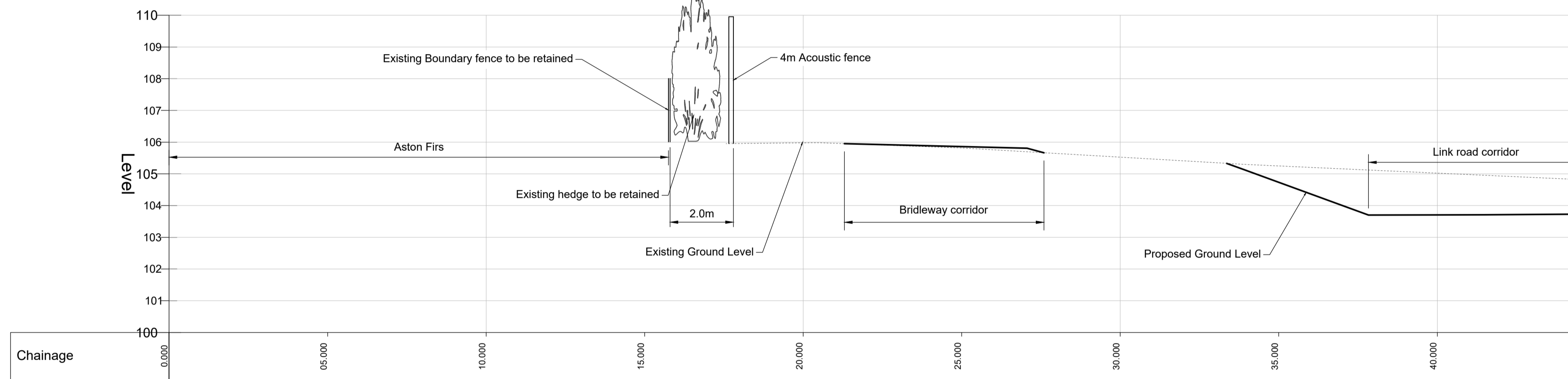

SECTION 2  
SCALE: H 1:100, V 1:100. DATUM: 100.000

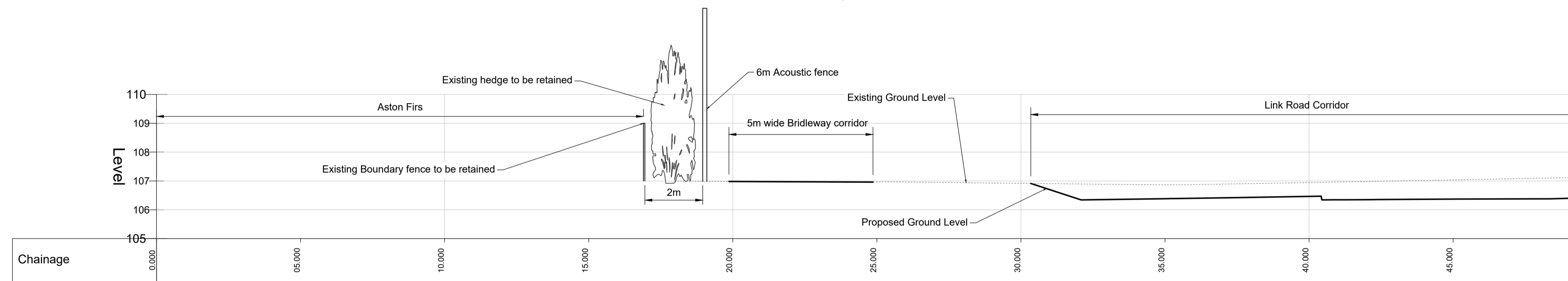

SECTION 3  
SCALE: H 1:100, V 1:100. DATUM: 105.000

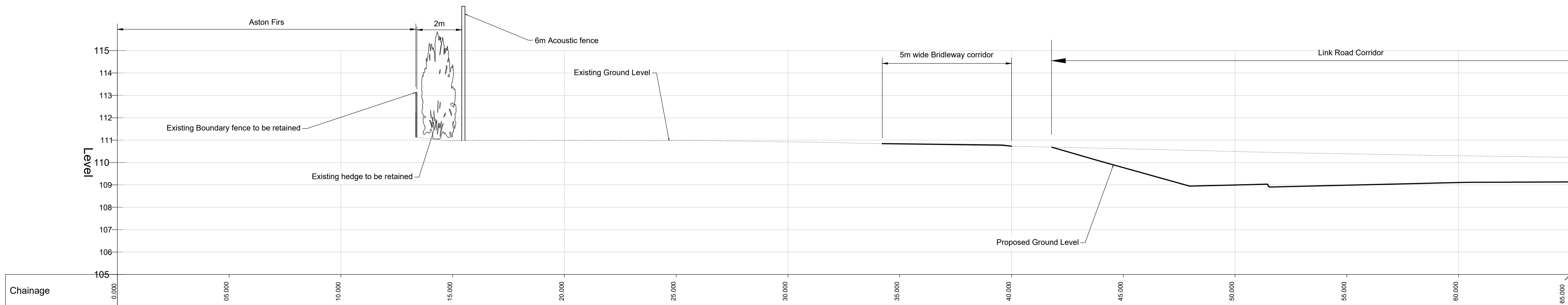

SECTION 4  
SCALE: H 1:100, V 1:100. DATUM: 105.000

Notes

- Do not scale this drawing. All dimensions must be checked/ verified on site.
- This drawing is to be read in conjunction with all relevant architects, engineers and specialists drawings and specifications.
- All dimensions in metres unless noted otherwise. All levels in metres unless noted otherwise.

For cross section locations, see Document 2.30A (HRF-BWB-GEN-XX-SK-CH-SK149)

P01	08.01.24	For Information	DF	SC
Rev	Date	Details of issue / revision	Drw	Rev

Issues & Revisions

Birmingham | 0121 233 3322  
 Leeds | 0113 233 8000  
 London | 020 7407 3879  
 Manchester | 0161 233 4260  
 Nottingham | 0115 924 1100  
[www.bwbconsulting.com](http://www.bwbconsulting.com)

Client

Project Title

**HINCKLEY NATIONAL RAIL  
FREIGHT INTERCHANGE**

Drawing Title

**ASTON FIRS SECTIONS**

Drawn:	D.Fraser	Reviewed:	S.Carter
BWB Ref:	NTT2814	Date:	08.01.24
Scale@A1:	1:100		

FOR INFORMATION

Project - Originator - Zone - Level - Type - Role - Number	Status	Rev
HKF-BWB-GEN-XX-SK-CH-SK150	S2	P01

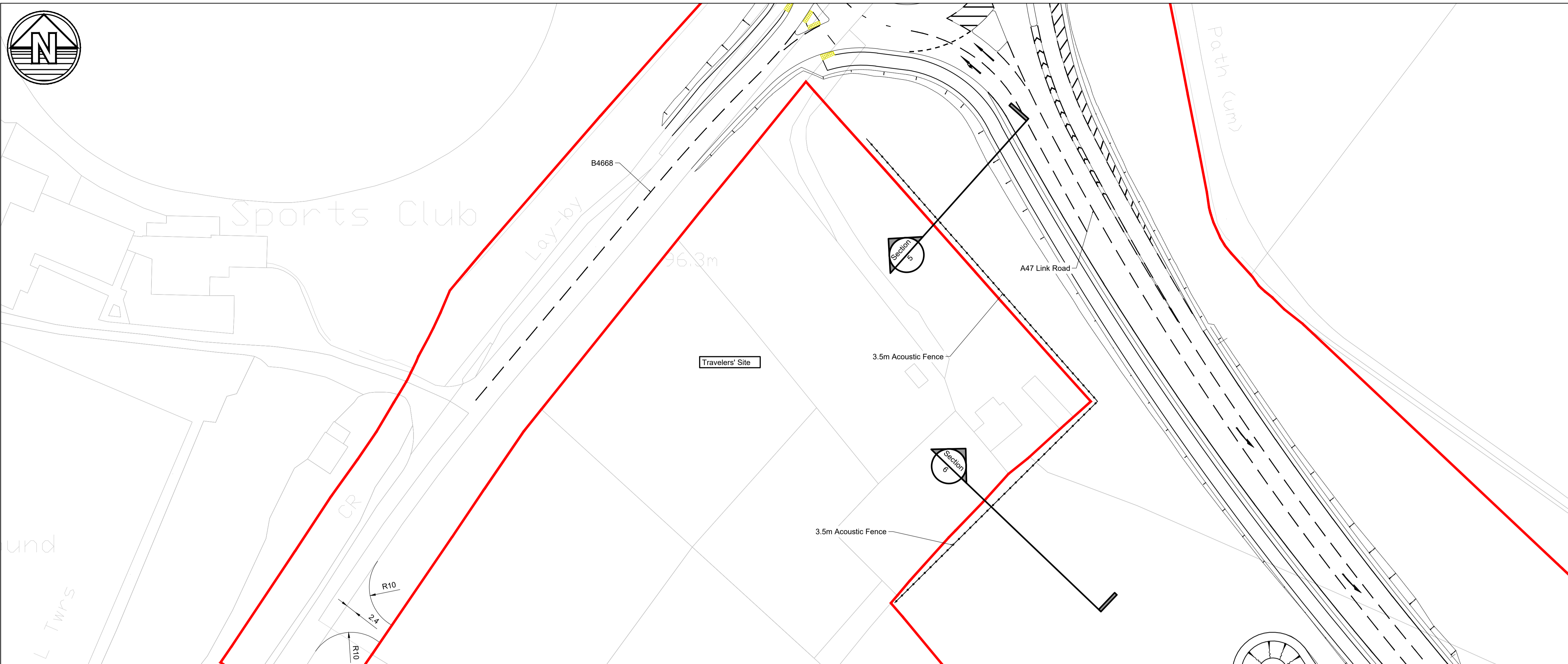
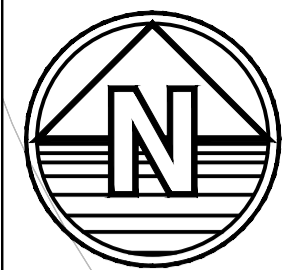

**Notes**

1. Do not scale this drawing. All dimensions must be checked/ verified on site.
2. This drawing is to be read in conjunction with all relevant architects, engineers and specialists drawings and specifications.
3. All dimensions in metres unless noted otherwise. All levels in metres unless noted otherwise.

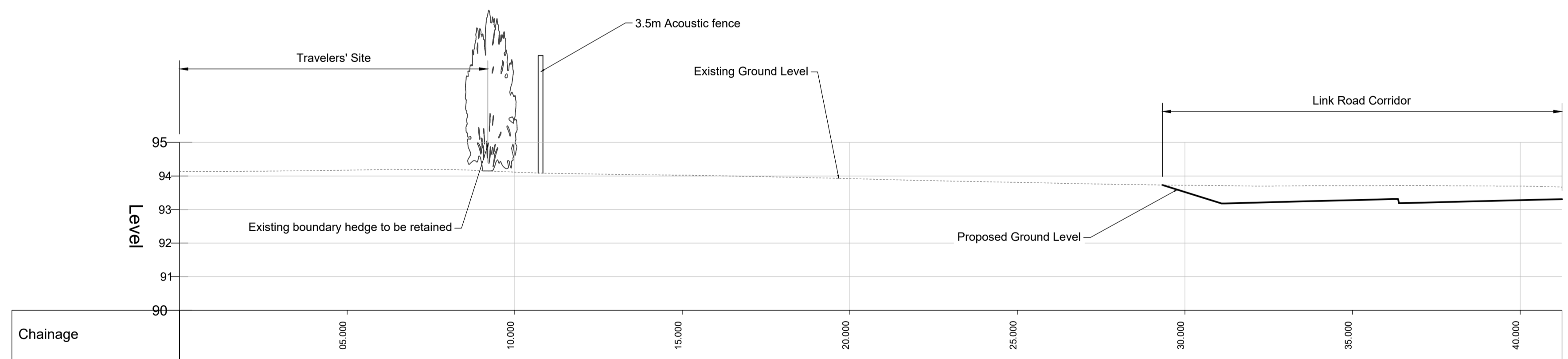

**SECTION 5**  
SCALE: H 1:100, V 1:100. DATUM: 90.000

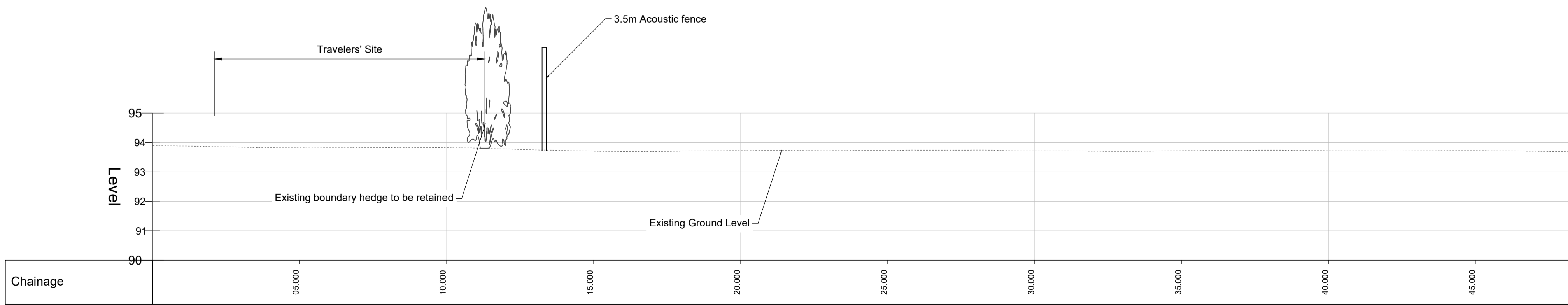

**SECTION 6**  
SCALE: H 1:100, V 1:100. DATUM: 90.000

P01	08.01.24	For Information	DF	SC
Rev	Date	Details of issue / revision	Drw	Rev

**Issues & Revisions**

Birmingham | 0121 233 3322  
 Leeds | 0113 233 8000  
 London | 020 7407 3879  
 Manchester | 0161 233 4260  
 Nottingham | 0115 924 1100  
[www.bwbconsulting.com](http://www.bwbconsulting.com)

Client



Project Title  
**HINCKLEY NATIONAL RAIL FREIGHT INTERCHANGE**

Drawing Title  
**NORTHERN ACOUSTIC FENCE SECTIONS**

Drawn:	D.Fraser	Reviewed:	S.Carter
BWB Ref:	NTT2814	Date:	08.01.24
Scale:	A1:	1:100	

**FOR INFORMATION**

Project - Originator - Zone - Level - Type - Role - Number	Status	Rev
HKF-BWB-GEN-XX-SK-CH-SK151	S2	P01